

## Fig.IN 529

Stalen blindflens volgens DIN 2527, EN1092-5 type A P250GH, afmetingen en boring volgens DIN PN10, Fig.IN 529.

Steel blind flange according to DIN 2527, EN1092-5 type A P250GH, dimensions according to DIN PN10, Fig.IN 529.

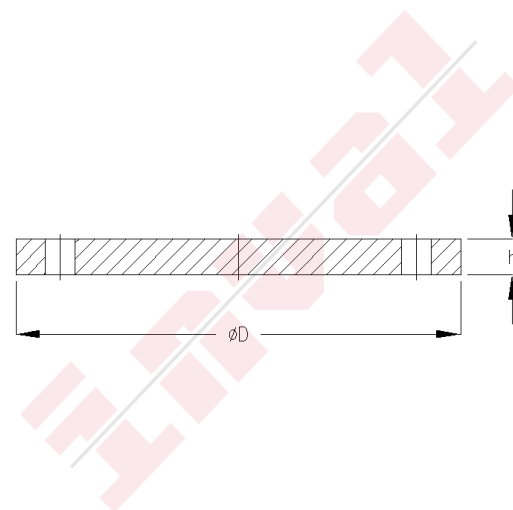

### OPMERKINGEN / REMARKS

### MATERIAAL / MATERIAL

|             |               |          |           |        |
|-------------|---------------|----------|-----------|--------|
| Huis / Body | Staal / Steel | St. 37-2 | EN S235JR | 1.0037 |
|-------------|---------------|----------|-----------|--------|

### AFMETINGEN / DIMENSIONS

| DN   | 15   | 20   | 25   | 32   | 40   | 50   | 65   | 80   | 100  | 125  | 150  | 200  | 250   | 300   | 350   | 400   | 450   | 500   |  |  |
|------|------|------|------|------|------|------|------|------|------|------|------|------|-------|-------|-------|-------|-------|-------|--|--|
| ØD   | 95   | 105  | 115  | 140  | 150  | 165  | 185  | 200  | 220  | 250  | 285  | 340  | 395   | 445   | 505   | 565   | 615   | 670   |  |  |
| h    | 14   | 16   | 16   | 16   | 16   | 18   | 18   | 20   | 20   | 22   | 22   | 24   | 26    | 26    | 26    | 26    | 28    | 28    |  |  |
| PCD  | 65   | 75   | 85   | 100  | 110  | 125  | 145  | 160  | 180  | 210  | 240  | 295  | 350   | 400   | 460   | 515   | 565   | 620   |  |  |
| nxd  | 4x14 | 4x14 | 4x14 | 4x18 | 4x18 | 4x18 | 4x18 | 8x18 | 8x18 | 8x18 | 8x22 | 8x22 | 12x22 | 12x22 | 16x22 | 16x26 | 20x26 | 20x26 |  |  |
| Kilo | 0,7  | 1    | 1,2  | 1,8  | 2,1  | 2,9  | 3,7  | 4,8  | 5,6  | 8,4  | 10,4 | 16,1 | 24,9  | 30,9  | 40,6  | 49,4  | 75,2  | 41,1  |  |  |